

**SYSTEM**

PWS 70 IW TT A type

**NOTE.**

사용 가능 유리

복층유리 : 22mm, 24mm

삼중유리 : 35mm

진공유리 : 27.3mm

열관류율

복층유리 : 1.3 W/m<sup>2</sup>K

삼중유리 : 1.1 W/m<sup>2</sup>K

진공유리 : 0.7 W/m<sup>2</sup>K

REV.	DESCRIPTION	DATE
△		
△		
△		
△		
△		

CODE NO.

PROJECT TITLE

DRAWING NAME

DRAWING BY

CHECKED BY

DATE

APPROVED BY

DRAWING NO

FILE NAME

(주)이건창호  
인천광역시 미추홀구 영전로 91 (도화동)  
T 1522-1271 F (032) 760 0697

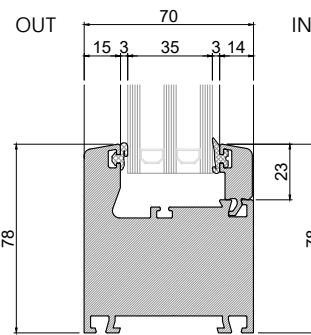
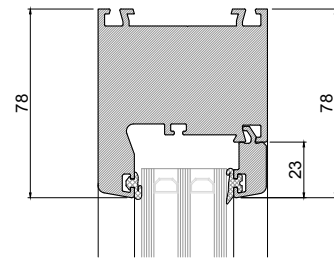
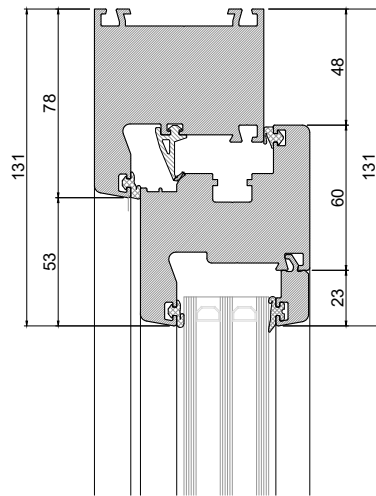

VERTICAL SECTION (B-B')

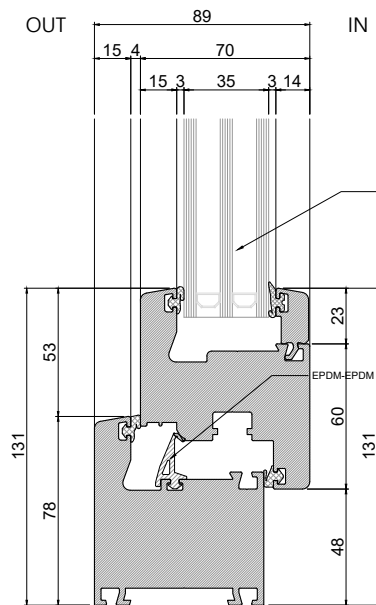

VERTICAL SECTION (A-A')

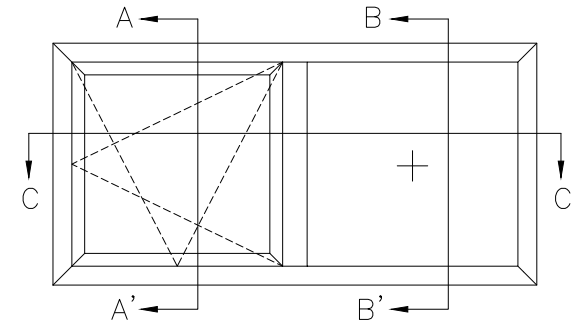
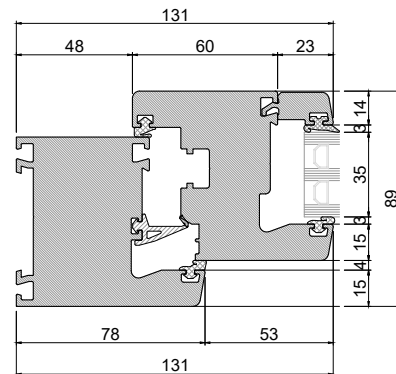

ELEVATION

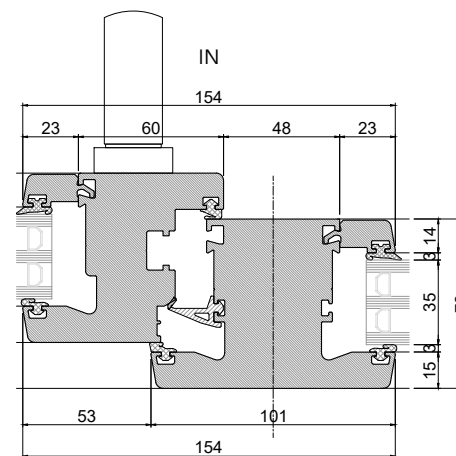

OUT

HORIZONTAL SECTION (C-C')

